

# MFX 23-CG

Steel  
Zinc plated

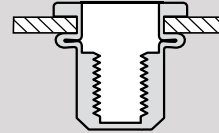
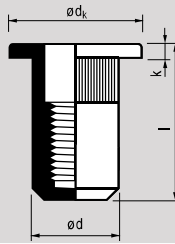

## MASTERGRIP I closed end I cylindrical head

$\emptyset d$		$l$ [+0,5/-0]		Item nr.	$\emptyset dk$ [+0/-0,5]	$k$ $\leq$	$\emptyset d$ [+0/-0,2]			
[mm]		[mm]	[mm]		[mm]	[mm]	[mm]	[Nm]	[N]	[N]
<b>M3</b>	*	15,0	0,5-2,5	<b>23M03CG1</b>	7,0	0,9	4,9	3,0	4.900	900
	*	16,0	2,5-4,0	<b>CG2</b>						
$\emptyset 5,0$										
<b>M4</b>	=	16,0	0,5-3,0	<b>23M04CG1</b>	9,0	1,1	5,9	4,5	7.840	1.660
	*	19,0	3,0-5,5	<b>CG2</b>						
$\emptyset 6,0$										
<b>M5</b>	=	18,5	0,5-3,0	<b>23M05CG1</b>	10,0	1,1	6,9	7,8	11.070	2.760
	*	21,5	3,0-5,5	<b>CG2</b>						
$\emptyset 7,0$	*	24,5	5,5-8,0	<b>CG3</b>						
<b>M6</b>	=	21,5	0,5-3,0	<b>23M06CG1</b>	12,0	1,6	8,9	20,0	17.640	3.430
	*	24,0	3,0-5,5	<b>CG2</b>						
$\emptyset 9,0$	*	26,5	5,5-8,0	<b>CG3</b>						
<b>M8</b>	=	26,0	0,5-3,0	<b>23M08CG1</b>	15,0	1,6	10,9	29,0	27.440	4.410
	*	28,5	3,0-5,5	<b>CG2</b>						
$\emptyset 11,0$	*	31,0	5,5-8,0	<b>CG3</b>						
	*	33,5	8,0-10,5	<b>CG4</b>						
<b>M10</b>	*	28,0	0,5-3,0	<b>23M10CG1</b>	16,0	2,1	11,9	32,0	29.400	4.900
	*	33,0	3,0-6,0	<b>CG2</b>						
$\emptyset 12,0$	*	36,0	6,0-9,0	<b>CG3</b>						
	*	39,0	9,0-12,0	<b>CG4</b>						

=	identical to old program
!	improved technical data
*	addition